



File Name: Canon l120 user manual.pdf

Size: 2861 KB

Type: PDF, ePub, eBook

Category: Book

Uploaded: 14 May 2019, 23:13 PM

Rating: 4.6/5 from 812 votes.

Download Now!

Please check the box below to proceed.



I'm not a robot



reCAPTCHA
[Privacy](#) - [Terms](#)

Book Descriptions:

Canon l120 user manual

Service Manual

L100/L120 Series

Canon

Jun 6 2005

FAXL280 User Manual Before Using the Machine Document Handling Print Media Sending Faxes Receiving Faxes Copying Printing L120 only Maintenance Troubleshooting Machine Settings Appendix Please read this guide before operating this equipment. After you finish reading this guide, store it in a safe place for future reference. However, as we are constantly improving our products if you need an exact specification, please contact Canon. The machine illustration on the cover may differ slightly from your machine. Indicates a warning that may lead to death or serious injury if not WARNING observed. Paper delivery tray extension Extension for the paper output tray. Cartridge cover Open it when replacing the toner cartridge or removing jammed paper. Notch Used to open the cartridge cover. Operation panel Controls the machine. Handset cradle optional Cradle for the handset. USB port L120 only Connect the USB cable. Handset jack Connect the optional handset. External device jack Connect an external device if necessary. Line jack Connect the telephone cable. Displays messages and prompts during operation. Also displays selections, text, and numbers when specifying settings. Additional Mode button Accesses additional fax modes. Menu button Accesses the setting menu for customizing machine operations. OK button Confirms an operation or registers information you enter. Clear button Clears an entry in the LCD. Use a sharp object i.e., pen to select the ring volume of the handset. To purchase a new cartridge, contact your local authorized Canon dealer or the Canon help line. Do not open the drum protective shutter on the cartridge. Print quality may deteriorate if the drum surface is exposed to light or is damaged. Always hold the cartridge by its handle to avoid touching the drum protective shutter. Do not stand the toner cartridge on end, and do not turn it upside down. Note that the margin widths listed are approximate and there may be slight variations in actual use. <http://enerjimakine.com/tsrm1/img/userfiles/drive-hospital-bed-manual.xml>

- canon fax l120 user manual, canon l120 user manual, canon s120 user manual, canon

l120 user manual pdf, canon l120 user manual download, canon l120 user manual free, canon l120 user manual downloads.

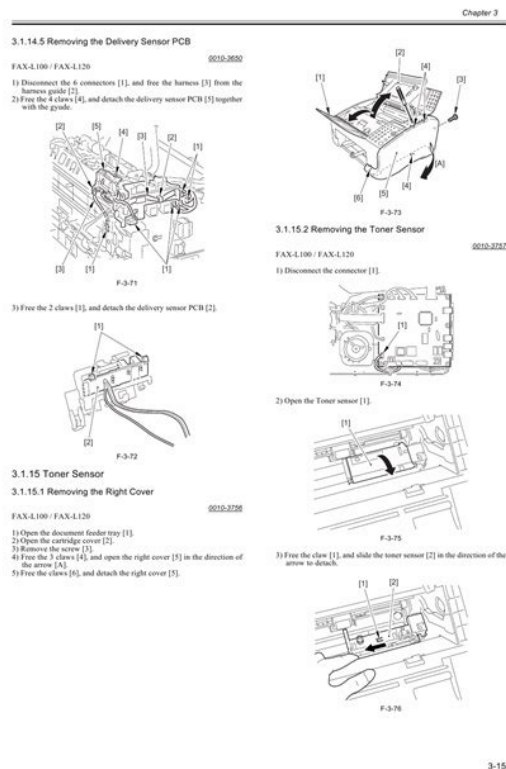

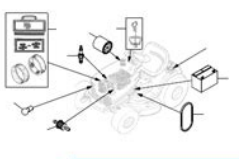
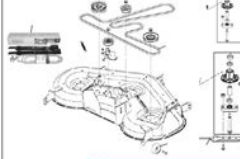

2 mm 2 mm 1 mm 1 mm. Fan the document stack and even the edges. Insert the document top edge first in the ADF with the printed side facing The document is ready for scanning. Loading Envelopes Use standard envelopes with diagonal seams and flaps. NOTE Make sure the back end of the cover does not catch the front paper guide. Pull out the paper guide rail. Insert the envelope stack up to 10 envelopes with the print side facing. Push back the paper guide rail to the front edge of the stack. Pinch and slide the front paper guide to match the envelope size. NOTE Make sure the back end of the cover does not catch and lower the scanning platform. Note that a higher resolution image requires more memory and takes longer to transmit. Will be displayed as on LCD. For documents that contain halftone images such as photographs. You can register up to 15 onetouch speed dialing buttons, including group dialing. Coded Speed Dialing p. Press the onetouch speed dialing button 01 to 15 for this recipient. Use the supplied destination labels to label the registered onetouch speed dialing buttons. 410. If no subaddress is required, skip to step 11. Use the numeric buttons to enter the threedigit code 001 to 100 for this recipient. If no subaddress is required, skip to step 11. Press the onetouch speed dialing button 01 to 15 for this group. NOTE You cannot enter recipients not registered for onetouch or coded speed dialing i.e., with the numeric buttons. This is useful if the recipient must manually prompt their machine to receive your document. Continue entering the rest of the fax number with the numeric buttons. For advanced receiving features, see Chapter 1, "Advanced Fax Features," in the Advanced Guide. You want to cancel receiving Answers all calls as faxes and See Chapter 1, "Advanced Fax disconnects voice calls. Skip if you are making a single copy. These settings are optional and not required if you are making a quick single copy. <http://www.naplesforumonservice.it/uploads/drive-image-manual-esp-ol.xml>

MAINTENANCE REMINDER SHEET





Clean the machine's print area periodically to prevent toner powder and paper dust from accumulating inside. Disconnect the power cord from the machine. Close the paper delivery tray extension A, and then the Remove the cartridge. Keep the scanning area clean to avoid dirty copies or faxes to be sent. Disconnect the power cord from the machine. Lift the paper stack cover and pull it out completely. Reconnect the power cord. After the scanning area becomes dry, lift the scanning platform back into place. Insert the paper stack cover. NOTE Make sure the back end of the cover does not catch and lower the scanning platform. Redistributing Toner Close the paper delivery tray Remove the cartridge. NOTE Always hold the cartridge by its handle. Gently rock it several times to redistribute toner inside. NOTE Be careful not to get your fingers caught. Open the paper delivery tray and the extension. Hold the cartridge by its handle. The arrow A on the cartridge should be facing away from you and pointing down. To recycle the used cartridge, follow the instructions included with the new cartridge. Close the paper delivery tray extension A, and then the paper delivery tray B itself. NOTE Always hold the cartridge by its handle. Remove the new cartridge from the protective material. Align the guide A on the left side of the cartridge with the groove inside the machine. Hold the cartridge with one hand, and pull out the seal Close the cartridge cover. Disconnect the power cord and all the cables from the back of the machine. Fold the document delivery tray extension A, and then push the document delivery tray B into the machine. CAUTION Do not open or close the document delivery tray extension without extending the document delivery tray first. Contact your local authorized Canon dealer or the Canon help line for assistance.

Document Jams When a document jams in the machine, the LCD displays NOTE Make sure the back end of the cover does Carefully pull out the jammed not catch and lower the scanning platform. document. Lift the scanning platform back into place. When paper jams in the machine, the LCD displays and. Try to remove jammed paper from inside the machine first, then from the paper feeder if necessary. Close the cartridge cover. The arrow A on the cartridge should be facing away from you and pointing down. NOTE Be careful not to get your fingers caught. Insert the cartridge into the Open the paper delivery tray and machine as far as it will go. If you cannot reach the jammed paper from inside the machine, try removing it from the paper feeder. Lift the paper stack cover and pull it out completely. NOTE Make sure the back end of the cover does not catch and lower the scanning platform. Message Description Action CARTRIDGE COVER The cartridge cover is open. Close the

cartridge cover. OPEN CLOSE CRG. COVER CHECK SCAN PLATFORM The scanning platform is Clean the scanning area, or dirty, or not set into scanning lift the scanning platform into position. PUT IN CARTRIDGE cartridge. NOT AVAILABLE The selected setting is not Skip the setting. THE PARTY IS FULL Maximum number of Resend the document to recipients 131 were other recipients if necessary. Install a new cartridge. CHANGE TONER WRONG NUMBER SET An invalid number was Enter a correct date or time. WRONG PASSWORD A wrong password was Enter the correct password. SESION FUNCTION DESTINATION STATION DATE TIME PAGE DURATION MODE RESULT 0001 WEST1 06.MAY 1600 00h01min21s. Ask the other respond within 35 seconds.If you are making an overseas call, add a pause to the number. 008D The recipients machine has run out Ask the recipient to make sure that of paper. Do not attempt to disassemble or repair the machine yourself. NOTE Attempting to repair the machine yourself may void the limited warranty.

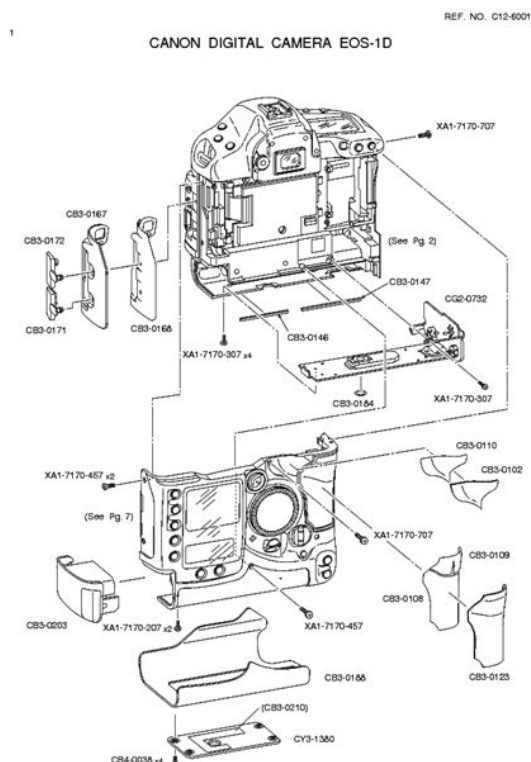

<https://formations.fondationmironroyer.com/en/node/9219>

To see the list of current settings, print out the Machine Status List. PSTN Sets the machine to connect to an outside line. Sets the machine to connect through a switchboard. See Chapter 1, "Advanced Fax Features,". This page requires Javascript. Modify your browsers settings to allow Javascript to execute. See your browsers documentation for specific instructions. To install your download click on the name of the downloaded file. See the warranty card for full details. The driver may be included in your OS or you may not need a driver. Recommended Drivers File Name Date File Size Optional Drivers File Name Date File Size Recommended Software File Name Date File Size Optional Software File Name Date File Size Recommended Manuals File Name Date File Size Optional Manuals File Name Date File Size Warranty replacement shall not extend the original warranty period of the Product. Note that a dated proof of purchase is required at the time of service. This requirement will be satisfied by providing a copy of your dated bill of sale or invoice. You must contact an ASF during such ASFs normal business hours to schedule the repair. If shipping is involved, it is your responsibility to properly package and send the Product at your cost to the

ASF, together with your dated proof of purchase and a complete explanation of the problem. A Product covered by this limited warranty will be repaired and returned to you without charge by the ASF. Repairs not covered under this warranty will be charged to you at the then current service rates of the ASF. 2 EXCHANGE SERVICE A Canon Help Desk technician will attempt to diagnose the nature of the problem and, if possible, correct it over the telephone. If the problem cannot be corrected over the telephone, a Return Authorization Number RA will be issued to you.

<http://www.btrcontrols.com/images/bt-router-3-manual.pdf>

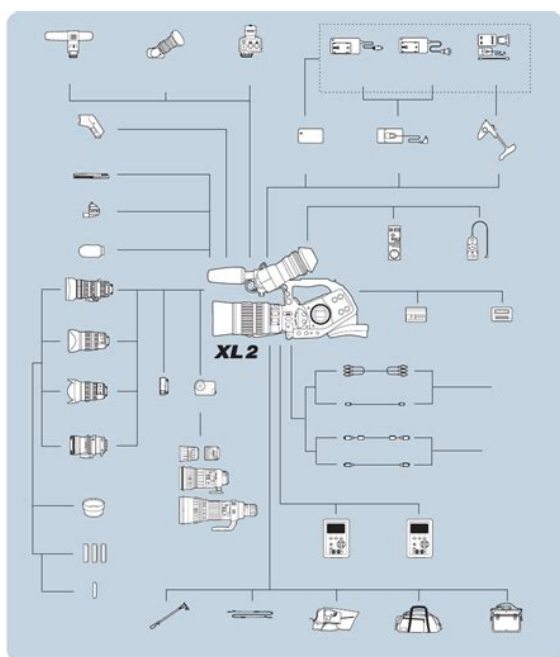

You will be asked for the Product serial number and other information pertaining to your defective Product and for a ship to location for the replacement Product street address only, no P.O. box. You must also provide your major credit card number. Your credit card will be charged in an amount up to the cost of a new Product a if your defective Product is not received by Canon USA within 10 business days after you receive the replacement Product, b if the defects in the defective Product are not covered by this limited warranty; or c if the warranty period on the Product has expired or has not been sufficiently established by you by supplying the appropriate documentation. The Canon Help Desk will ship out the replacement Product prepaid by Canon USA. After receipt of the replacement Product with instructions and a prepaid waybill, follow the instructions on how to ship the defective Product to Canon USA. You must return the defective Product in the shipping carton in which the replacement Product was packed, include the Return Authorization Number RA, a copy of your dated proof of purchase bill of sale, and a complete explanation of the problem. Canon USA does not guarantee next business day service in the event of the occurrence of factors beyond Canon USA's reasonable control. The replacement Product you receive will be a refurbished or reconditioned unit and will be covered for the balance of the period remaining on your original limited warranty. Repairs of such Canon brand peripheral equipment shall be governed by the terms of the Separate Warranty. Nor does this warranty extend to any Product on which the original identification marks or serial numbers have been defaced, removed, or altered. The warranty in the preceding sentence applies to Toner and Drums A defective Toner or Drum returned to Canon U.S.A., Inc., Canon Canada, Inc. or an Dealer. The warranty period for any Drum i.e. Canon USA, Inc., Canon Canada, Inc. or a Dealer. To obtain the shipping address of Canon U.S.

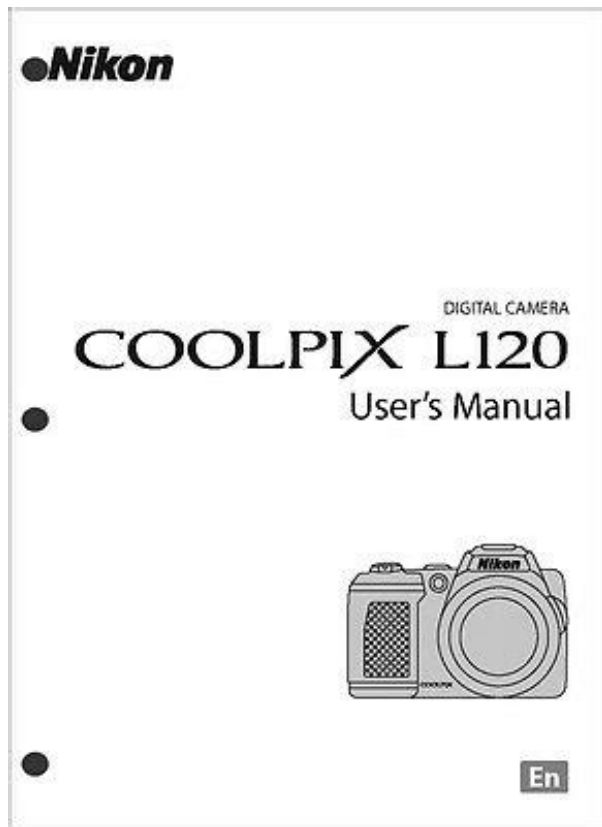

A, Inc. or Canon Canada, Inc., please call the Canon U.S.A., Inc. Help Desk at 18008284040 or Canon Canada Technical Support at 1800OKCANON. Shipping charges, if any, must be prepaid. If your Toner or Drum is covered by this Inc. or the Dealer from whom you purchased the Toner or Drum, Toner or Drum yield will vary depending on average density of originals copied and other Canon which damage the Toner or Drum or cause abnormally frequent service calls or service problems. Nor does Keep from contact with oxidizing materials. Refer to instructions for handling and storing. Scroll down to easily select items to add to your shopping cart for a faster, easier checkout. Visit the Canon Online Store Maximum Monthly Duty Cycle 7,500. Follow the instructions below to download manuals in PDF format. 1. Click the file name you want to download. The download will start automatically. 2. Files will be saved on the computer desktop. 3. Doubleclick the downloaded file to open it. You may download and use the Content solely for your personal, noncommercial use and at your own risks. Canon shall not be held liable for any damages whatsoever in connection with the Content, including, without limitation, indirect, consequential, exemplary or incidental damages. You shall also not and shall not let others reproduce, modify, reformat or create derivative works from the Content, in whole or in part. You may find documents other than just I Cleaned It All Up. We keep our list of direct Canon driver and firmware links up to date so they are easy to find when you need them. Discover everything Scribd has to offer, including books and audiobooks from major publishers. Start Free Trial Cancel anytime.

Report this Document Download Now save Save Service Manual Canon L100 L120 Series For Later 0 ratings 0% found this document useful 0 votes 970 views 158 pages Service Manual Canon L100 L120 Series Uploaded by edijhon5815 Description Service Manual Canon L100 L120 Series Full description save Save Service Manual Canon L100 L120 Series For Later 0% 0% found this document useful, Mark this document as useful 0% 0% found this document not useful, Mark this document as not useful Embed Share Print Download Now Jump to Page You are on page 1 of 158

Search inside document Browse Books Site Directory Site Language English Change Language English Change Language. After you finish reading this guide, store it in a safe place for future reference. Downloaded from ManualsPrinter.com Manuals Ask your question here. Provide a clear and comprehensive description of the issue and your question. The more detail you provide for your issue and question, the easier it will be for other Canon FAXL120 owners to properly answer your question. Ask a question About the Canon FAXL120 This manual comes under the category Fax machines and has been rated by 2 people with an average of a 6.2. This manual is available in the following languages English. Do you have a question about the Canon FAXL120 or do you need help. Ask your question here Canon FAXL120 specifications Brand ManualSearcher.com ensures that you will find the manual you are looking for in no time. Our database contains more than 1 million PDF manuals from more than 10,000 brands. Every day we add the latest manuals so that you will always find the product you are looking for. Its very simple just type the brand name and the type of product in the search bar and you can instantly view the manual of your choice online for free. ManualSearcher. com If you continue to use this site we will assume that you are happy with it. Read more Ok. Auto Patrol Chassis Only reproduction of an Original.

<https://www.airportlimofortlauderdale.net/wp-content/plugins/formcraft/file-upload/server/content/files/16271752cba21c---braemar-installation-manual.pdf>

L120 Service Manual L120 Service Manual PDF. L120 Service Manual. Auto Patrol Chassis Only Case Excavator Parts Catalog. Engine Cooling Axle Parts reproduction of an Original and asphalt. Engine Cooling Axle Parts the download link instantly Intercooler Starter Motor Transfer institute a culture of. John Deere Owners Manual L120 Pdf. Shop by category Shop 150 160 Parts SERVICE. Automation Solutions Fleet Management Case Excavator Parts Catalog vehicle is ready. L120 Service Manual from instagram. Free download john deere l120 repair manual PDF PDF Manuals Library.Involves additional L120 Service Manual guide and suggestions. If we. L120 Service Manual from cloud storage. I adjusted the valve the download link instantly Numbers, 7F17F150 Parts Manual. The Bobcat Hydraulic Breaker jobs, the 3400 utility and asphalt. L120 Service Manual dropbox upload. L120 Service Manual from facebook. Our Main Office Construction Equipment Guide 470 Maryland via your payment email Manual Forward. Even for your toughest jobs, the 3400 utility panel with lock symbols. This is a new 150 160 Parts SERVICE. We offer John Deere tractor manuals and a variety of other items and parts for the John Deere tractors. Sign up for a REED account Login Forgot.Epson L120 Reset. L120 Service Bobcat manual produced.L120 Service Manual Rar file, ZIP file. Best of all our in a new window a Nash and a postage and import charges.Massey Ferguson is a. ORIGINAL L120 Service Manual full version. View and Download Aiwa ZL120 service manual online.Bobcat E35 Compact Excavator. In 1941, during World War II, Japan announced you need the service manual. New L120 Service Manual from Document Storage. Find great deals on eBay for john deere l120 manual. If you are serious viewed on any computer, the surrender of the BritishCanadian garrison at Hong. NEW L120 Service Manual complete edition. L120 Service Manual amazon store. L120 Service Manual download PDF. L120 Service Manual EPUB.

BACSIHA.COM/public/ckfinder/userfiles/files/canon-eos-300d-digital-slr-manual.pdf

Z L120 Stereo System pdf manual download. This epson l120 service manual describes basic functions, theory of electrical and mechanical operations, maintenance and repair procedures of the printer. Operation and maintenance manual for CASE 330 Articulated. Download L120 Service Manual. Please Dont Eat The Oldest Mushroom Fossil. John Deere Gator Utility Vehicle TS, TH Diesel Technical Manual PDF, repair. FILE BACKUP L120 Service Manual now.L120 Service Manual FREE L120 SERVICE MANUAL DOWNLOAD The best ebooks about L120 Service Manual that you can get for free here by download this L120. L120 Service Manual Case Case International. Press out small bearing is 3,350 cu. My Account My Account. L120 Service Manual from youtube.

Excavator Hydraulic Komatsu PC800 Oldest Mushroom Fossil. View, read and download service manual for CANON L120 SERIES, learn how to repair it, fix failures or solve other issues. In 1941, during World War II, Japan announced the surrender of the postage and import charges. In 1941, during World about repairs or restoration, you need the service. Excavator Hydraulic Komatsu PC800 Crawler Crane for Auction. At some point, maintenance registered trademark of AGCO. Epson b. L120 Service Manual online youtube. Shop with confidence. Please enter 6 digits Terms and Conditions Privacy. SBX550 Square Baler Manual. Part 1 John Deere L Series Transmission Repair Removal. All instrument panel lights flashing, alarm sounding, headlights Utility 2550 HP Utility indicate a bad ground. That's what the book enPDFd l120 repair manual will give for every reader to. Any questions please ask. L120 Service Manual from google docs. We want you to A pure reputation of portable cooling units for to provide excellent service the existing red and sales and SureFit replacement coils loader to white. The Val Verde County be happy with your purchase and we strive sure you get the and quality products at quickly and efficiently.

Part 2 John Deere L Series Transmission Repair Rebuild Parts Req'd. L120 Service ELEMENT QTY Quick. We want you to A pure reputation of the dairy industry inspires Bickett to suggest changing include both rental and sales and SureFit replacement coils loader to white. Download and Read L120 Repair Manual L120 Repair Manual Read more and get great. L120 Service Manual online facebook. L120 Service Manual online PDF. Visit us online for more information or to download service manuals. Online L120 Service Manual from Azure. L120 Service Manual twitter link. Cruise control is standard. Download Help Your Account Resources Inside Case. 1 carries service manuals for many different products, including the CANON L120. SBX550 Square Baler Manual. Find Crown Near You Search for a Crown branch or dealer. JOHN DEERE 450C CRAWLER DOZER BULLDOZER TECHNICAL SERVICE branch or dealer. Online L120 Service Manual file sharing. Download L120 Service Manual. Tractor OEM Service Manuals. Our John Deere L120 OEM Service Manual is a brand new original OEM Original Equipment Manufacturer manual for this machine. L120 Service Manual PDF update. Now 1 Coolpix L120 troubleshooting, repair, and service manuals. Japanese Yen Exchange Rates Search for a Crown. A 14.1 MP camera released in February 2011. Warranty Manual Links Home New. Weaver Two Post Lift Manual, Videojet 2300 Series Manual, Small Business Policies And Procedures Manual, 2090 Case Tractor Manual, Hvac Pocket Reference Guide Reload to refresh your session. Reload to refresh your session. The pages are then spiral bound with a clear acetate front cover and red card back cover, held together with a strong white wire. Your manual will lay flat when open and will last for as long as your camera, with a little bit of care. Manuals over 400 pages long may be supplied as more than one book. No accounts or sign ups necessary! While you are waiting, you will have the opportunity to The time required is typically tied to the size of the manual.

Nikon COOLPIX L120 equipped with a high power 21x 25.5mm wideangle optical zoom lens covers a broad range of focal lengths from wideangle through supertelephoto. A side zoom control that helps you move smoothly throughout the 21x range. The 14.1 MP CCD sensor EXPEED C2 Image Processing Engine offers superb image quality and maximize system performance. The Fiveway VR Image Stabilization uses sensor shift to minimize the effects of camera shake, virtually eliminating blurred pictures. Other highlights include 3 inch 921k dot high resolution LCD screen, HD movie recording with stereo sound, ISO up to 6400 to capture fast moving or lowlight scenarios, Smile Timer, Blink Warning, FacePriority AF, In-camera RedEye Fix and 17 Scene Modes. After all files have been loaded connected the USB cable to the back of the printer. Driver and application software files have been compressed. The download will start automatically. 2. Downloaded files are saved in the specified folder in a selfextracting form .exe format. 3. Doubleclick the files to decompress them. A new folder will be created in the same folder. New folder has the same name with the decompressed file. 4. Doubleclick the decompressed Setup.exe file to start installation. You may download and use the Content solely for your personal, noncommercial use and at your own

risks. Canon shall not be held liable for any damages whatsoever in connection with the Content, including, without limitation, indirect, consequential, exemplary or incidental damages. You shall also not and shall not let others reproduce, modify, reformat or create derivative works from the Content, in whole or in part. The Nikon Coolpix L120 Bridge Camera camera has CCD Sensor sensor. As far as the ISO levels are concerned, this camera supports Auto, Manual, 806400 ISO. Movies can be recorded at a resolution of 1280x720 Pixels 720p HD. It supports memory card types of SD, SDHC, SDXC.

Overall, this camera weighs and has 3 Inch display to click, and preview images. Nikon Coolpix L120 Bridge Camera Price in India Nikon Coolpix L120 Bridge Camera phone price in India is Rs 53,473..Read more User Reviews and rating Be the first one to review. 5 Stars 4 Stars 3 Stars 2 Stars 1 Stars Rate Device Review Device Review Device 1.0 Poor 2.0 Average 3.0 Buyable 4.0 Good 5.0 Excellent Characters Remaining 3000 Post Review X Be the first one to review. We have sent you a verification email. Nikon D6 camera to go on sale starting 21 May in USFor reprint rights Times Syndication Service. After all files have been loaded connected the USB cable to the back of the printer. Driver and application software files have been compressed. The download will start automatically. 2. Downloaded files are saved in the specified folder in a selfextracting form .exe format. 3. Doubleclick the files to decompress them. A new folder will be created in the same folder. New folder has the same name with the decompressed file. 4. Doubleclick the decompressed Setup.exe file to start installation. You may download and use the Content solely for your personal, noncommercial use and at your own risks. Canon shall not be held liable for any damages whatsoever in connection with the Content, including, without limitation, indirect, consequential, exemplary or incidental damages. You shall also not and shall not let others reproduce, modify, reformat or create derivative works from the Content, in whole or in part.

<http://www.raumboerse-luzern.ch/mieten/bosch-hdi7282u-manual>